

Dossier CMP Arles : 783

Page/Sheet 1/6

Client / Customer : AIR LIQUIDE AGS GmbH



Engineered System N° :

1 RESERVOIR DE STOCKAGE LIN 1000MT

1 x 1000MT LIN STORAGE TANK

ITEM B 72001

TUBULURE L6 (DN10)
NOZZLE L6
LIQUID PRESSURE PIPE

| | | | | | | | | | | | |
|-----------------------|--------------------------|----------|--------------------------|---|----------------------------|-------------|---|----------------------------|-------------|---|----------------------------|
| | | | | | | | | | | | |
| 1 | | 31/01/05 | HONNONS |  | 31/01/05 | HULIN |  | 31/01/05 | LEBOUCQ |  | |
| EDITION EDITION N° | REFERENCE CLIENT REF. | DATE | NOM NAME | SIGN. | DATE | NOM NAME | SIGN. | DATE | NOM NAME | SIGN. | ETAT D'AVANC. STATUS |
| | | | REDACTEUR DRAWN UP BY | | VERIFICATEUR CHECKED BY | | | APPROBATEUR APPROVED BY | | | |

Projet : **ASU No.9 KOSICE**
ProjectClassement CMP Arles : **783-117.L6**
CMP Arles document N°

Ce document est la propriété de CMP Arles. Il ne pourra sans autorisation écrite être utilisé ou communiqué à des tiers, toutes précautions utiles seront prises pour éviter sa divulgation.

This document is the property of the CMP Arles. It may not be used or transmitted to third parties without the written consent of the company.
All necessary precautions shall be taken to avoid disclosure.

revision number

All necessary precautions shall be taken to avoid disclosure.

CMP ARLESConstructions Métalliques
et Préfabrication d'Arles

1, Rue Copernic - Z.I. Nord - 13200 ARLES

☎: 04.90.93.33.30 - Téléfax:04.90.93.33.31

Mail:contact@cmaparles.com

DEPARTEMENT CRYOGENIE SOISSONS

13, Avenue de Coucy

02200 SOISSONS

☎: 03.23.93.60.69 - Téléfax:03.23.93.60.78

Mail: cryo.soissons@cmaparles.com

Dossier CMP Arles : 783

Page/Sheet 3/6

Client / Customer : AIR LIQUIDE AGS GmbH

Engineered System N° :

Rev 0

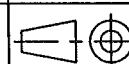
Plan N° : 783-117.L6

Echelle/Scale

ELEVATION

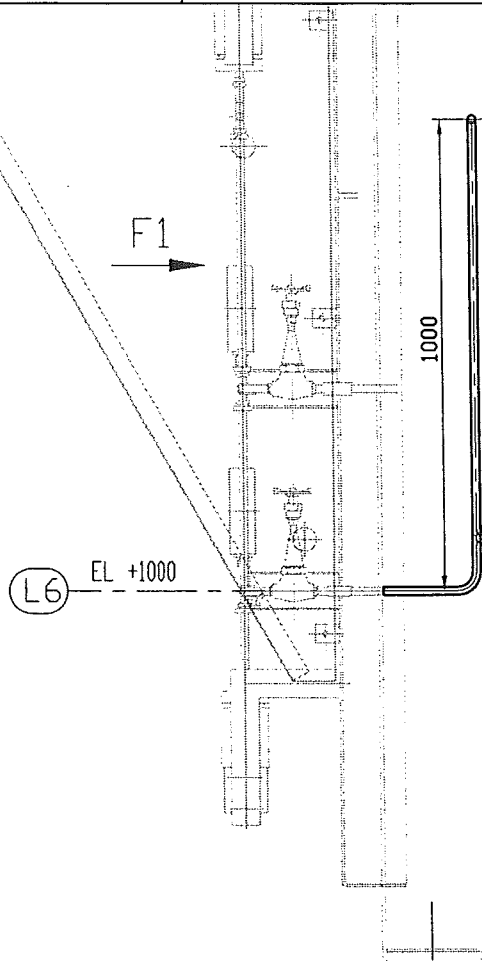
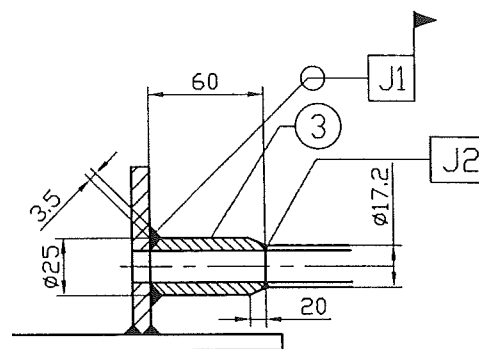
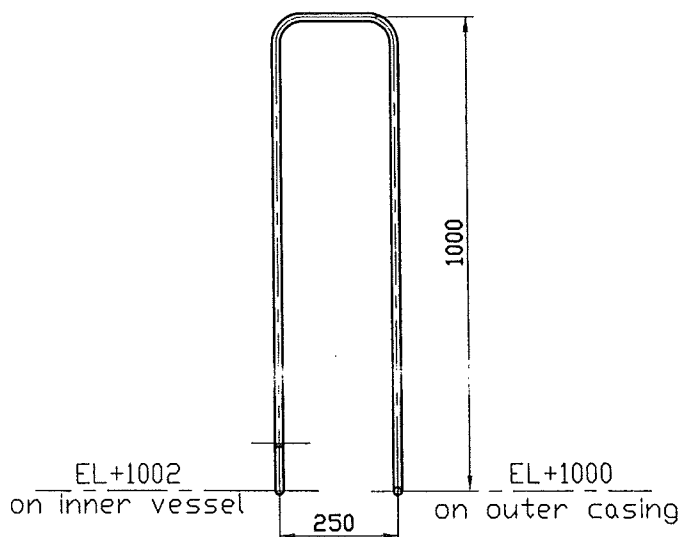
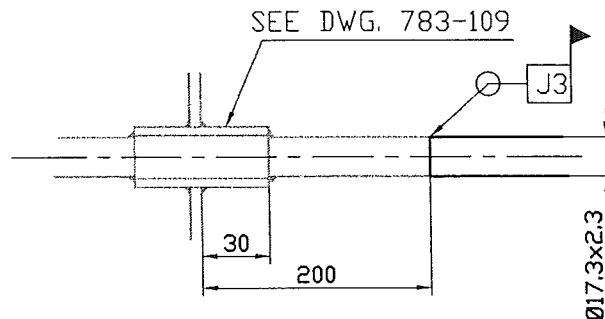
DETAIL 1
(NOT TO SCALE)**F1 VIEW****DETAIL 2**
(NOT TO SCALE)

NOTA: MIN. BENDING RADIUS 40 int
Welded joint J1-J2-J3 see WPS on page 6
For partlist see page 7

Ce document est la propriété de CMP Arles. Il ne pourra sans autorisation écrite être utilisé ou communiqué à des tiers, toutes précautions utiles seront prises pour éviter sa divulgation.

This document is the property of the CMP Arles. It may not be used or transmitted to third parties without the written consent of the company.
All necessary precautions shall be taken to avoid disclosure.

Dossier CMP Arles : 783

Page/Sheet 4/6

Client / Customer : AIR LIQUIDE AGS GmbH**Engineered System N° :**

Rev 0

Plan N° : 783-117.L6

PLAN VIEW

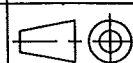
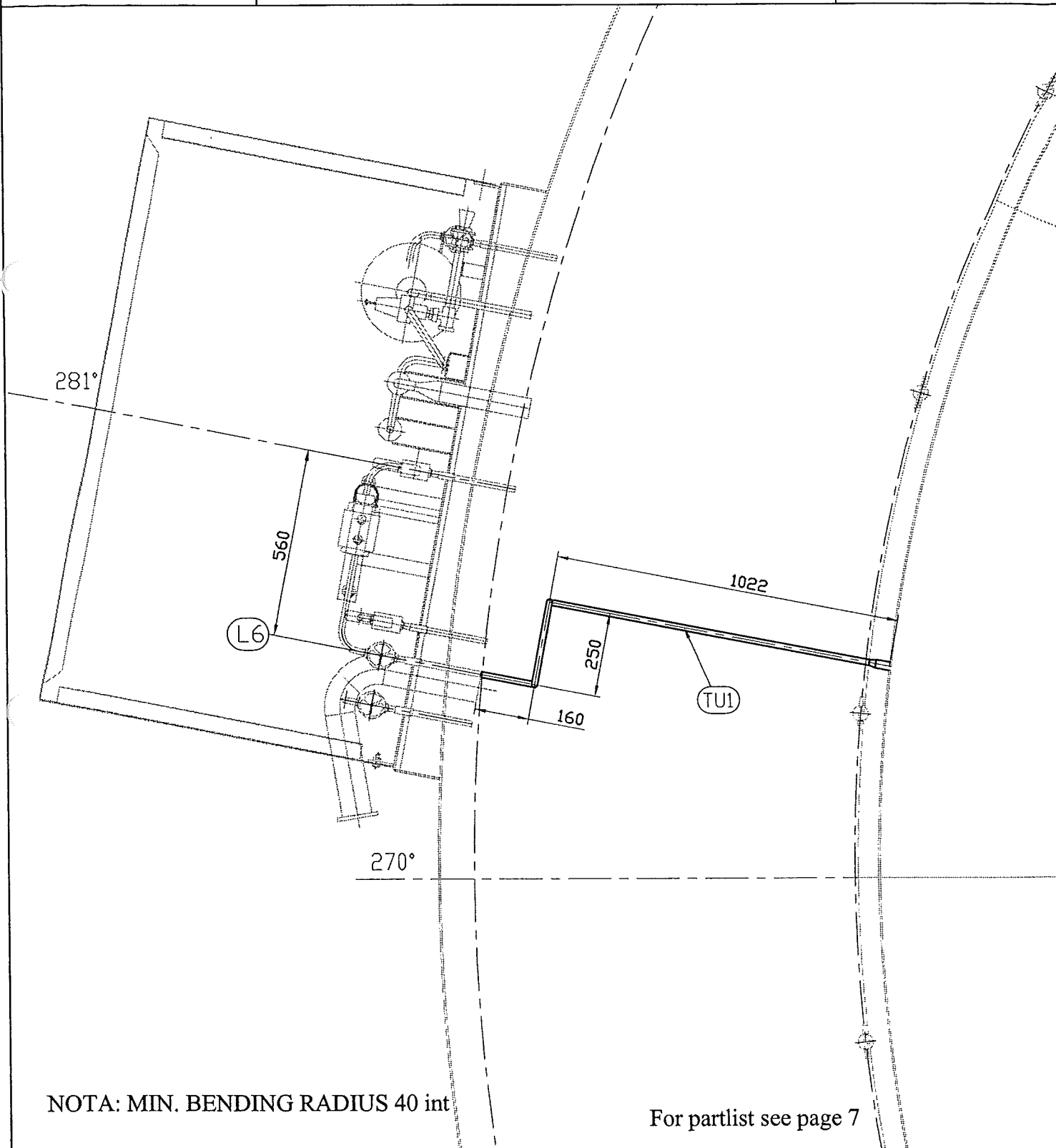
Echelle/Scale
1/15

NOTA: MIN. BENDING RADIUS 40 int

For partlist see page 7

Ce document est la propriété de CMP Arles. Il ne pourra sans autorisation écrite être utilisé ou communiqué à des tiers, toutes précautions utiles seront prises pour éviter sa divulgation.

This document is the property of the CMP Arles. It may not be used or transmitted to third parties without the written consent of the company.

All necessary precautions shall be taken to avoid disclosure.

Echelle/Scale

2)  = SITE WELDING

[illegible]

(4) see list on CRYO-CS1

This document is the property of the CMP Arles. It may not be used or transmitted to third parties without the written consent of the company.

Constructions Métalliques et Préfabrication d'Arles

1, Rue Copernic - Z.I. Nord - 13200 ARLES

☎: 04.90.93.33.30 - Téléfax:04.90.93.33.31

Mail:contact@comparles.com

DEPARTEMENT CRYOGENIE SOISSONS

13, Avenue de Coucy

02200 SOISSONS

☎: 03.23.93.60.69 - Téléfax:03.23.93.60.78

Mail: cryo.soissons@comparles.com

Dossier CMP Arles : 783

Page/Sheet 6/6

Rev 0

Client / Customer : AIR LIQUIDE AGS GmbH *Engineered System N° :*

Plan N° : 783-117.L6

NOMENCLATURE/LISTE DE COLISAGE

PART LIST/PACKING LIST

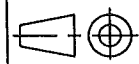

Echelle/Scale

/

| | | TUBULURE L6 (nozzle L6) | | | | | | |
|-------|-----|--|-----------------|---------------|--------|--------------|--------------|----------|
| S/E.1 | 1 | SUB-ASSEMBLY INCLUDING ITEMS: | | | | 4 | | |
| TU1 | 1 | TUBE Ø17,2x2,3 (pipe 3/8" sch 40S) seamless Lg:4000 (1) | A312 TP304L | / | | | | |
| 3 | 1 | ROND Ø25 (rod) | A479 304/304L | 3.1b | | | | |
| | | | | | | | | |
| | | | | | | | | |
| | | | | | | | | |
| | | | | | | | | |
| | | | | | | | | |
| | | | | | | | | |
| | | | | | | | | |
| | | | | | | | | |
| | | | | | | | | |
| | | | | | | | | |
| | | | | | | | | |
| | | | | | | | | |
| | | | | | | | | |
| | | | | | | | | |
| | | | | | | | | |
| | | | | | | | | |
| | | | | | | | | |
| | | | | | | | | |
| | | | | | | | | |
| | | | | | | | | |
| | | | | | | | | |
| | | | | | | | | |
| | | | | | | | | |
| | | | | | | | | |
| | | | | | | | | |
| | | | | | | | | |
| | | (1) including overlength of 200 mini | | | | 4 | | |
| | | | * or equivalent | | | | | |
| REP. | Qté | DESIGNATION | rev | NORME/NUANCE | CERTIF | POIDS NET kg | CERTIF N° or | VISA EXP |
| ITEM | Oty | DESIGNATION | rev | NORM/MATERIAL | CERTIF | NET WEIGHT | VISA EXP | |

| REP | Qty | DESIGNATION | rev | NORME/NUANCE | EN10204 | POIDS NET kg | CERTIF N° or |
|------|-----|-------------|-----|---------------|---------|--------------|--------------|
| ITEM | Qty | DESIGNATION | rev | NORM/MATERIAL | CERTIF | NET WEIGHT | VISA EXP |

SUPPLY BY CMP Arles

Ce document est la propriété de CMP Arles. Il ne pourra sans autorisation écrite être utilisé ou communiqué à des tiers, toutes précautions utiles seront prises pour éviter sa divulgation.

This document is the property of the CMP Arles. It may not be used or transmitted to third parties without the written consent of the company.

All necessary precautions shall be taken to avoid disclosure.